



# LeBooster

Beijing • Shanghai • Guangzhou • Shenzhen

**MORE THAN A BUSINESS CENTER**

# BUSINESS CENTERS IN CHINA

To help your company settle in China!

**We offer within a friendly working environment :**

- Open spaces and private offices
- Free meeting rooms
- Visio conference system
- 24/7 accessibility
- CCI FRANCE CHINE Membership in the City of location

4

Locations

72

Companies hosted

70

Private offices

212

Desks

# BUSINESS CENTER LOCATIONS

4 Business Centers in major Chinese Cities

BEIJING



SHANGHAI



GUANGZHOU



SHENZHEN

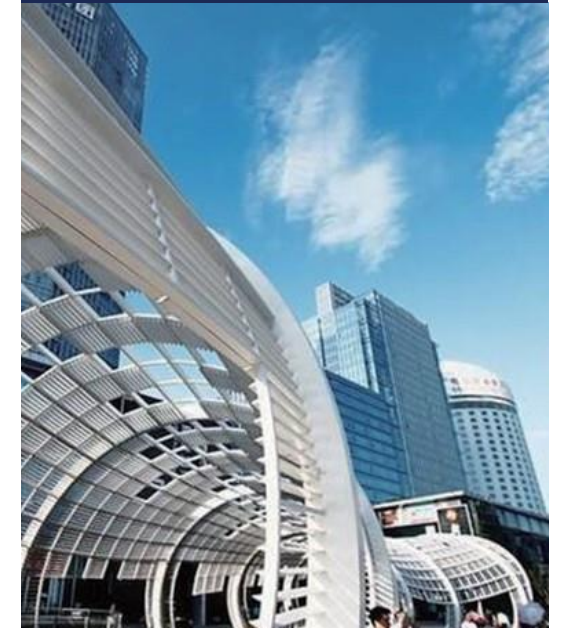

# PATRON MEMBERS

Join the 1<sup>st</sup> French network in China with more than 1600 members!



# INSTITUTIONAL PARTNERS

Get privileged contacts with our partners!

## OUR CHINESE PARTNERS



## OUR FRENCH PARTNERS





# LeBooster

## BEIJING

CCI FRANCE CHINE BUSINESS CENTER

**Anaëlle Wu**  
*Business Center Manager*  
[wu.anaelle@ccifc.org](mailto:wu.anaelle@ccifc.org)  
+86 10 6461 0260

**Morgan Lefevre**  
*Beijing Branch Director*  
[lefevre.morgan@ccifc.org](mailto:lefevre.morgan@ccifc.org)  
+86 10 6461 0260

**Walter Janvier**  
*Business Coordinator*  
[janvier.walter@ccifc.org](mailto:janvier.walter@ccifc.org)  
+86 10 6461 0260

# BEIJING LOCATION

CCI FRANCE CHINE is located in the heart of Sanlitun.

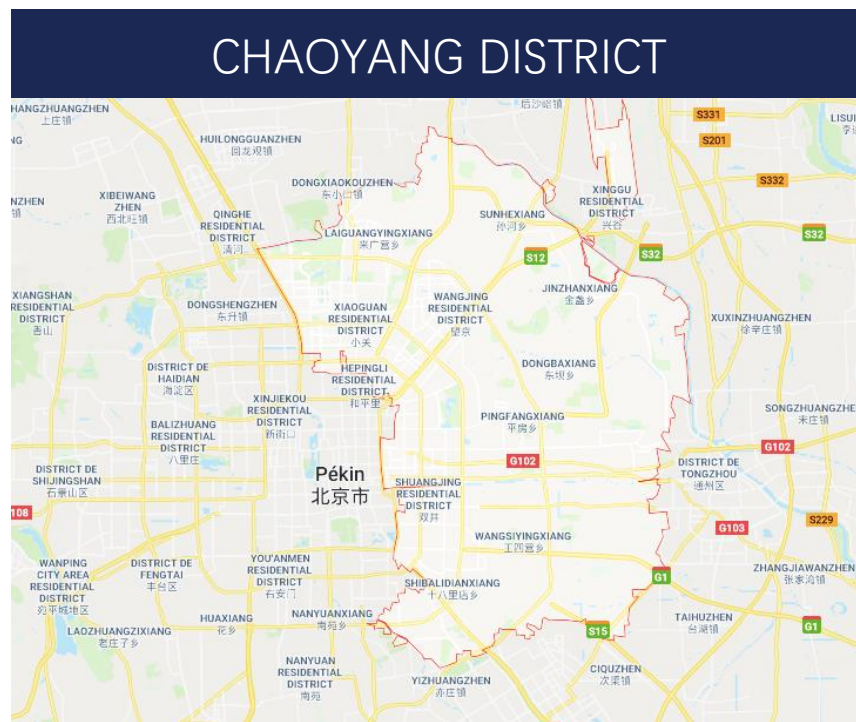

## Driving distance

- 30 Minutes from Beijing Capital Airport (PEK)
- 20 Minutes from Beijing South Railway

## Walking distance

- 10 Minutes from Tuanjiehu Metro Station
- 2 Minutes from Sanlitun Village

# BEIJING SPACES



RECEPTION AREA



LOBBY

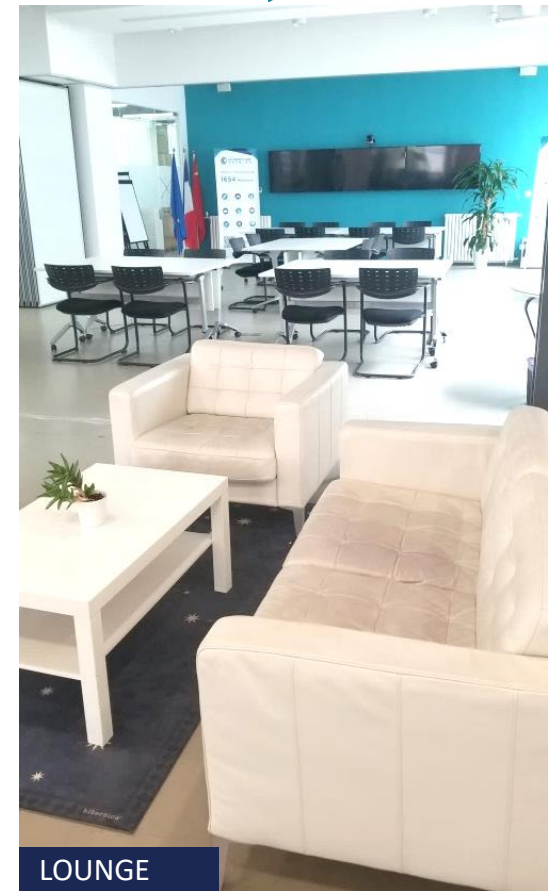

LOUNGE



OFFICE



CONFERENCE ROOM



CONFERENCE ROOM



# BEIJING SURFACES



24

Private offices

8

Desks in open space

## Private and equipped offices:

- Offices from 8 to 18 m<sup>2</sup>.
- Furnished
- Internet (Wi-Fi and fiber optic)
- Telephone (direct line and transfer)
- Scanner, photocopier, printer

# BEIJING OFFERS

MENTION	WORK STATIONS	PHONE LINES	PRICE* /MONTH
Working desk in open space	1	1	3,500 RMB
Medium private office	2 to 4	2	10,000 RMB
Grand private office	4 to 6	2+	10,000/14,000 RMB

\*Price subject to V. A. T. at 6.72%. Possibility to add phone line under request. Desk, Chairs, Phones & Closets provided.

## TERMS & CONDITIONS:

- **Contract** : 12 month basis
- **Deposit** : 2 months
- **Notification period** : 2 months
- **Invoicing** : monthly, in RMB
- **Payment** : RMB or EURO currencies accepted

# BEIJING SERVICES

 All included



**CCI FRANCE CHINE Beijing membership**  
→ publication into our yearly Directory



**Offices available for 24/7**  
→ with an individual electronic card.



**Free access to Conferences and Working groups**



**Free use of meeting rooms**  
→ Fully equipped with TVs and Visioconference system

→ Conference room (up to 50 seats) available under request according to availabilities

→ Free providing of facilities: screen and projectors, Confcall & Visioconf systems



**Internet** → WIFI + Wires



**Free Shared printer, scanner, copier**



**Private phone lines**  
→ direct line / extension via standard / call transfer



**Coffee, tea and water at-will.**



**Business center assistant**  
→ (Front desk): receive your guests, call forwarding, sending letters and parcels.



# LeBooster

## SHANGHAI

CCI FRANCE CHINE BUSINESS CENTER

**Anthony Lopez-M**  
*Deputy General Manager*  
[Lopez.anthony@ccifc.org](mailto:Lopez.anthony@ccifc.org)  
+86 159 0173 7053

**Lin Long**  
*Business center Officer*  
[Lin.long@ccifc.org](mailto:Lin.long@ccifc.org)  
+86 21 6132 7118

# SHANGHAI LOCATION

CCI FRANCE CHINE is located in the heart Jing 'An Business District.

## SHANGHAI



## JING'AN BUSINESS DISTRICT

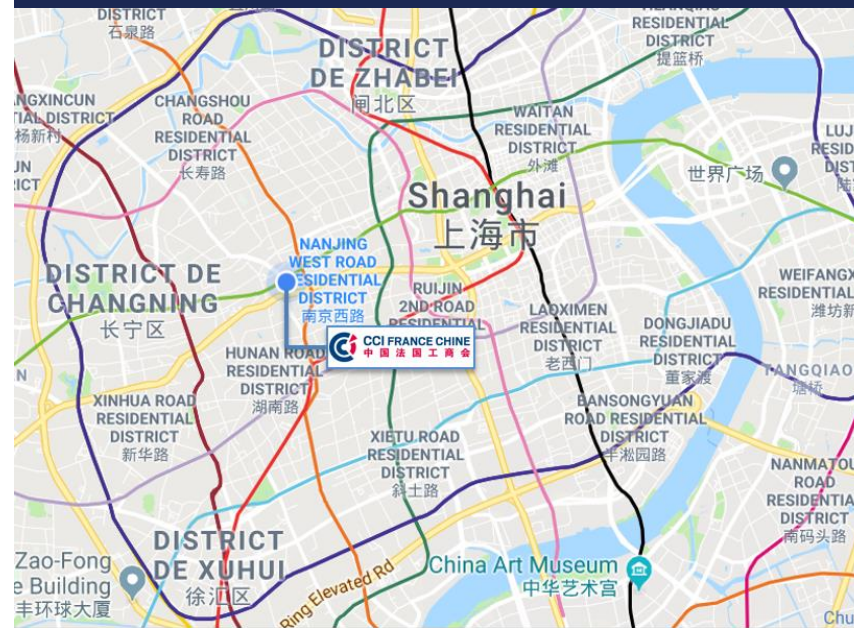

## 2/F, Mayfair Tower, 83 Fu Min Road

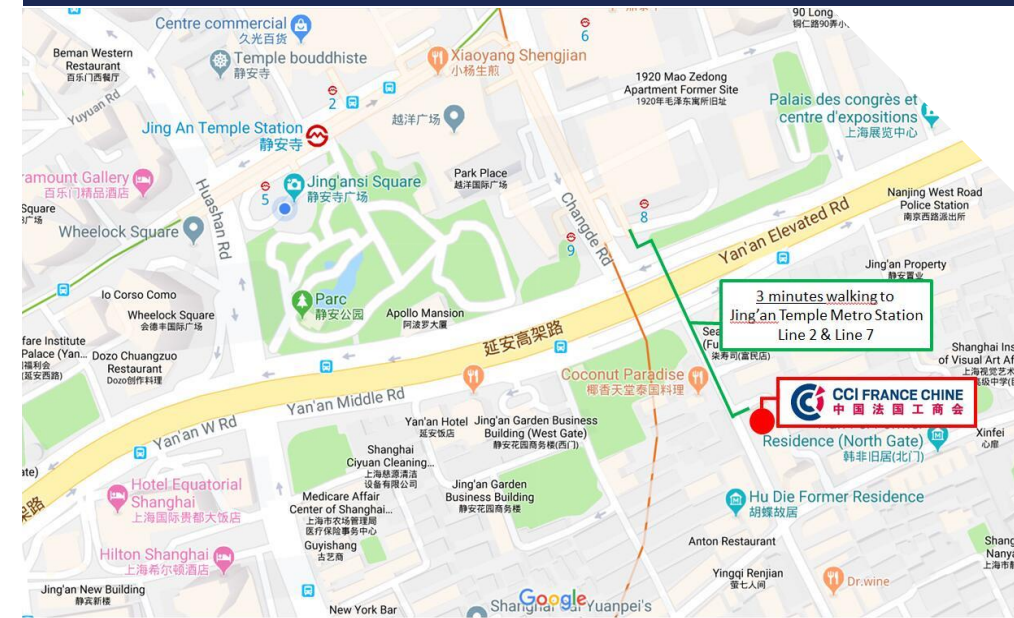

### Driving distance

- 45 Minutes to Pudong International Airport (PVG)
- 25 Minutes to Shanghai Hongqiao Airport (SHA)

### Walking distance

- 3 Minutes Jing'an Temple Metro Station
- 3 Minutes Nanjing West Road
- 5 Minutes Huaihai Middle Road

# SHANGHAI SPACES



RECEPTION AREA



MEETING ROOM



BOARD ROOM VISIOCONFERENCE



LOUNGE



LOBBY



CONFERENCE ROOM

# SHANGHAI SURFACES

33

6

Private offices

Desks in open space

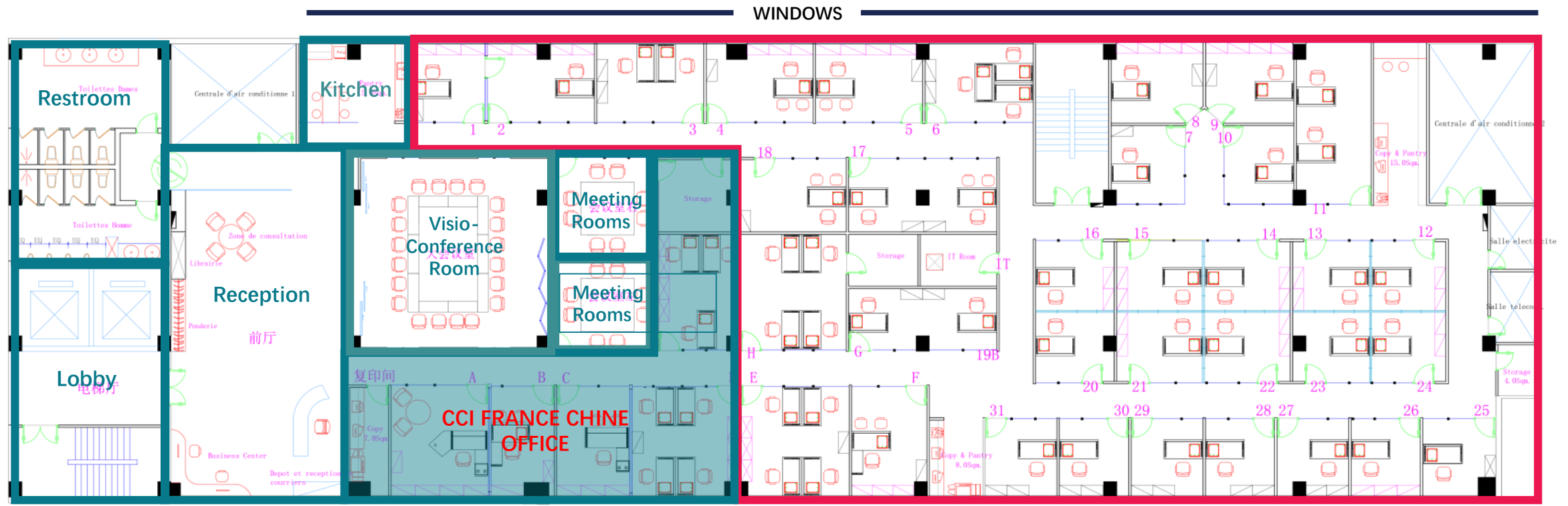

PUBLIC AREA

WINDOWS

BUSINESS CENTER

# SHANGHAI OFFERS

MENTION	WORK STATIONS	PHONE LINES	PRICE* IN RMB/ MONTH
Working desk in open space	1	1	4,635 RMB
Small Private Office	1-2	1	from 7,750 RMB
Medium Private Office	2-4	2+	from 8,820 RMB
Grand Private Office	6-8	4+	from 16,480 RMB

\*Price subject to V. A. T. at 6.72%. Possibility to add phone line under request. Desk, Chairs, Phones & Closets provided.

## TERMS & CONDITIONS:

- **Contract** : 12 month basis
- **Deposit** : 2 months
- **Notification period** : 2 months
- **Invoicing** : monthly, in RMB
- **Payment** : RMB or EURO currencies accepted



# SHANGHAI SERVICES



## CCI FRANCE CHINE Shanghai membership

→ publication into our yearly Directory



## Offices available for 24/7

→ with an individual electronic card.



## Free access to Conferences and Working groups



## Free use of meeting rooms

→ Fully equipped with TVs and Visioconference system

→ Conference room (up to 50 seats) available under request according to availabilities

→ Free providing of facilities: screen and projectors, Confcall & Visioconf systems



## Internet → WIFI + Wires



## All included



## Free Shared printer, scanner, copier



## Private phone lines

→ direct line / extension via standard / call transfer



## Coffee, tea and water at-will.



## IT Manager

→ free help in troubleshooting, installation software / printer / mailbox / internet connections, etc.



## Business center assistant

→ (Front desk): receive your guests, call forwarding, sending letters and parcels.



# LeBooster

## GUANGZHOU

CCI FRANCE CHINE BUSINESS CENTER

**Sarah DEFRANCE**

*Business Development Manager*  
[defrance.sarah@ccifc.org](mailto:defrance.sarah@ccifc.org)  
+86 (20) 2916 5529

**Ophélie YAN**

*South China Membership &  
Business Center Manager*  
[yan.ophelie@ccifc.org](mailto:yan.ophelie@ccifc.org)  
+86 (20) 2916 5530

# GUANGZHOU LOCATION

CCI FRANCE CHINE is located in the heart of the Zhujiang New Town.

## GUANGZHOU



## TIAN'HE BUSINESS DISTRICT

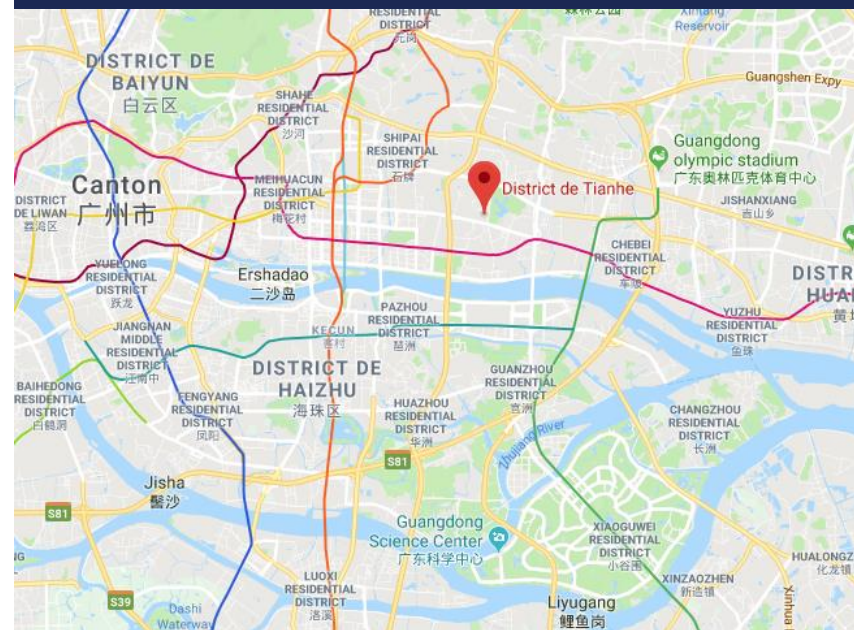

## Room 802, Leatop Plaza, 32 Zhujiang East Road

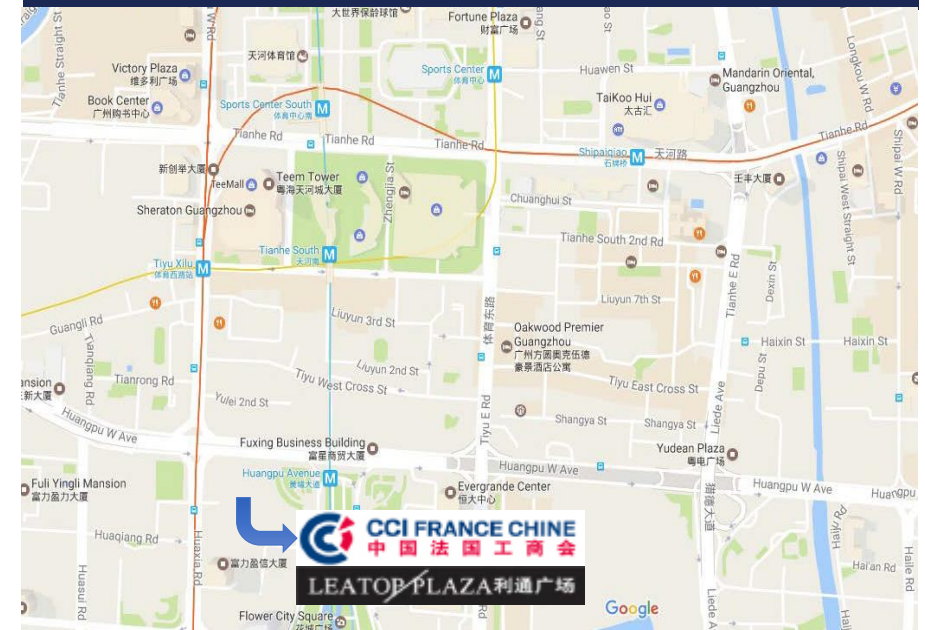

### Driving distance

- 40 Minutes from Baiyun International Airport (CAN.)
- 10 Minutes from Guangzhou East Railway Station

### Walking distance

- 10 Minutes from Tiyu Xilu Metro Station
- 2 Minutes from Huangpu Avenue APM Station

# GUANGZHOU SPACES



CONFERENCE ROOM



RECEPTION DESK



KITCHEN



OFFICE



CONFERENCE ROOM



OFFICE

# GUANGZHOU SURFACES

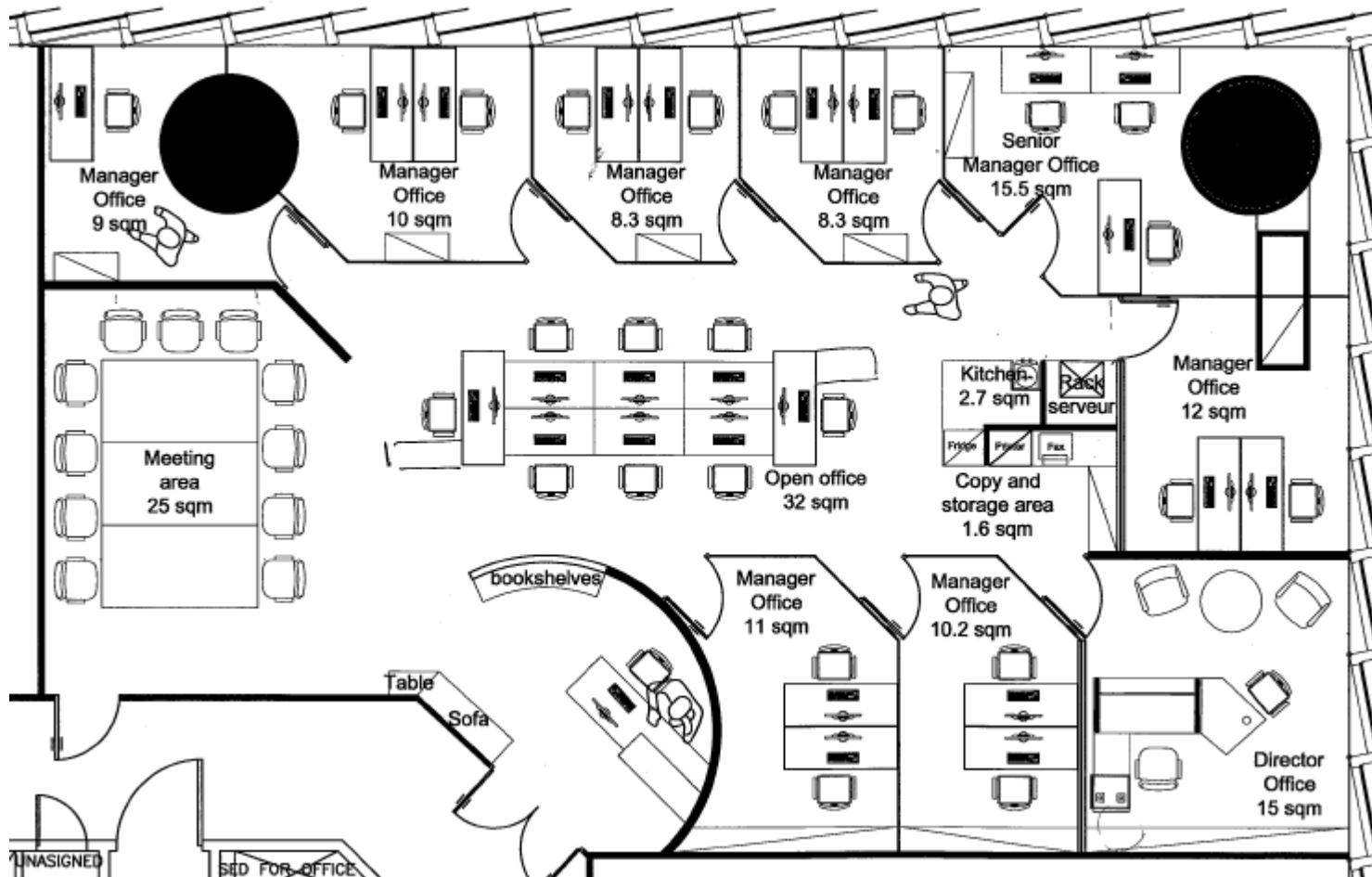

9

Private offices

8

Desks in Open Space

## Private and equipped offices:

- Offices from 8 to 15 m<sup>2</sup>.
- Furnished
- Internet (Wi-Fi and fiber optic)
- Telephone (direct line and transfer)
- Scanner, photocopier, printer

# GUANGZHOU OFFERS

MENTION	WORK STATIONS	PHONE LINES	PRICE* /MONTH
Working desk in open space	1	1	3,000 RMB
Medium private office	2	2	5,800 RMB
Grand private office	From 1 to 4	2+	6,800/7,800 RMB

\*Price subject to V. A. T. at 6.72%

Possibility to add phone line under request

Desk, Chairs, Phones & Closets provided

## TERMS & CONDITIONS:

- **Contract** : minimum 2 months - basic contract 12 month basis
- **Deposit** : 2 months
- **Notification period** : 2 months
- **Invoicing** : monthly, in RMB
- **Payment** : RMB or EURO currencies accepted

# GUANGZHOU SERVICES



**CCI FRANCE CHINE South China membership**  
→ publication into our yearly Directory



**Offices available for 24/7**  
→ with an individual electronic card.



**Free access to Conferences and Working groups**



**Free use of meeting rooms**  
→ Fully equipped with TVs and Visioconference system

→ Conference room (up to 50 seats) available under request according to availabilities

→ Free providing of facilities: screen and projectors, Confcall & Visioconf systems



All included



**Internet** → WIFI + Wires



**Free Shared printer, scanner, copier**



**Private phone lines**  
→ direct line / extension via standard / call transfer



**Coffee, tea and water at-will.**



**Business center assistant**  
→ (Front desk): receive your guests, call forwarding, sending letters and parcels.



# LeBooster

## SHENZHEN

CCI FRANCE CHINE BUSINESS CENTER

**Laurence LIU**  
*Commercial and Event Assistant*  
[liu.laurence@ccifc.org](mailto:liu.laurence@ccifc.org)  
+86 (755) 8632 9602

**Béatrice DE LA TULLAYE**  
*Shenzhen Branch Director*  
[delatullaye.beatrice@ccifc.org](mailto:delatullaye.beatrice@ccifc.org)  
+86 (755) 8632 9720



# SHENZHEN LOCATION

CCI FRANCE CHINE is located in the heart of the Nanshan District.

## SHENZHEN



## HIGH-TECH INDUSTRY PARK

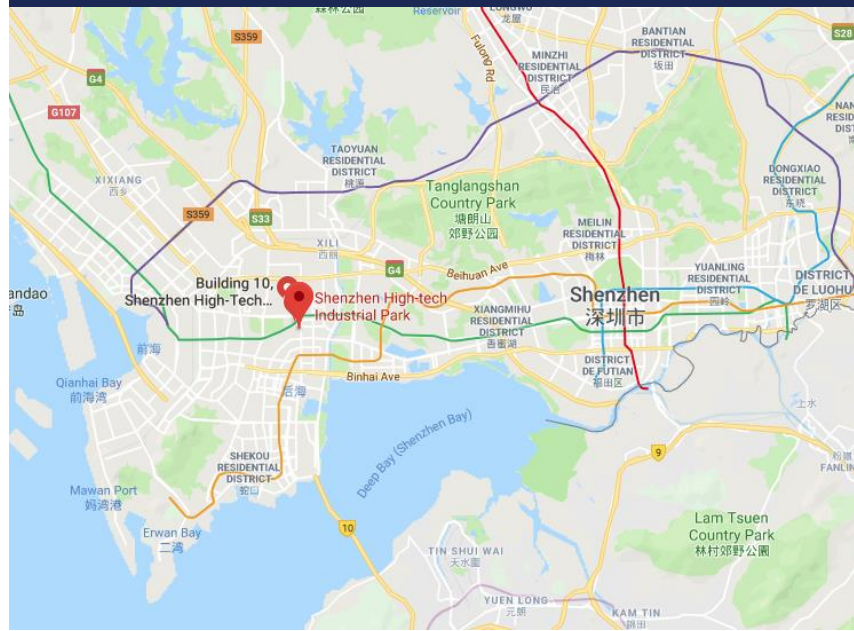

## Room 218, 2/F Chinese Overseas Scholars Venture Building



### Around us

- 2.2 km to Shenzhen Bay Park and Mixc
- 1.5 km to Shenzhen University

### Driving distance

- 40 Minutes from Shenzhen Bao'an International Airport
- 30 Minutes from Shenzhen bei Railway Station

### Walking distance

- 7 Minutes from Ke'uan Metro Station (Ligne 2, Exit C)
- 16 Minutes from Shenzhen University Metro Station (Ligne 1 Exit C)

# SHENZHEN SPACES



# SHENZHEN SURFACES

4

7

Private offices

Desks in Open Space

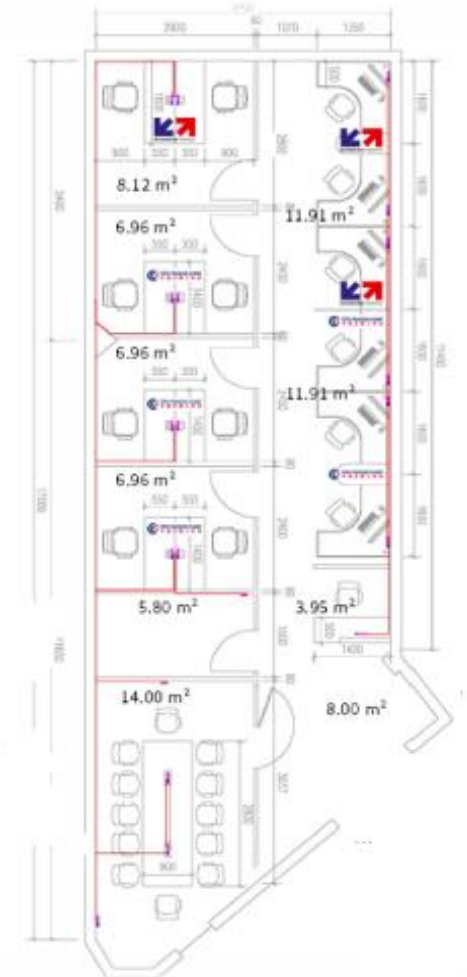
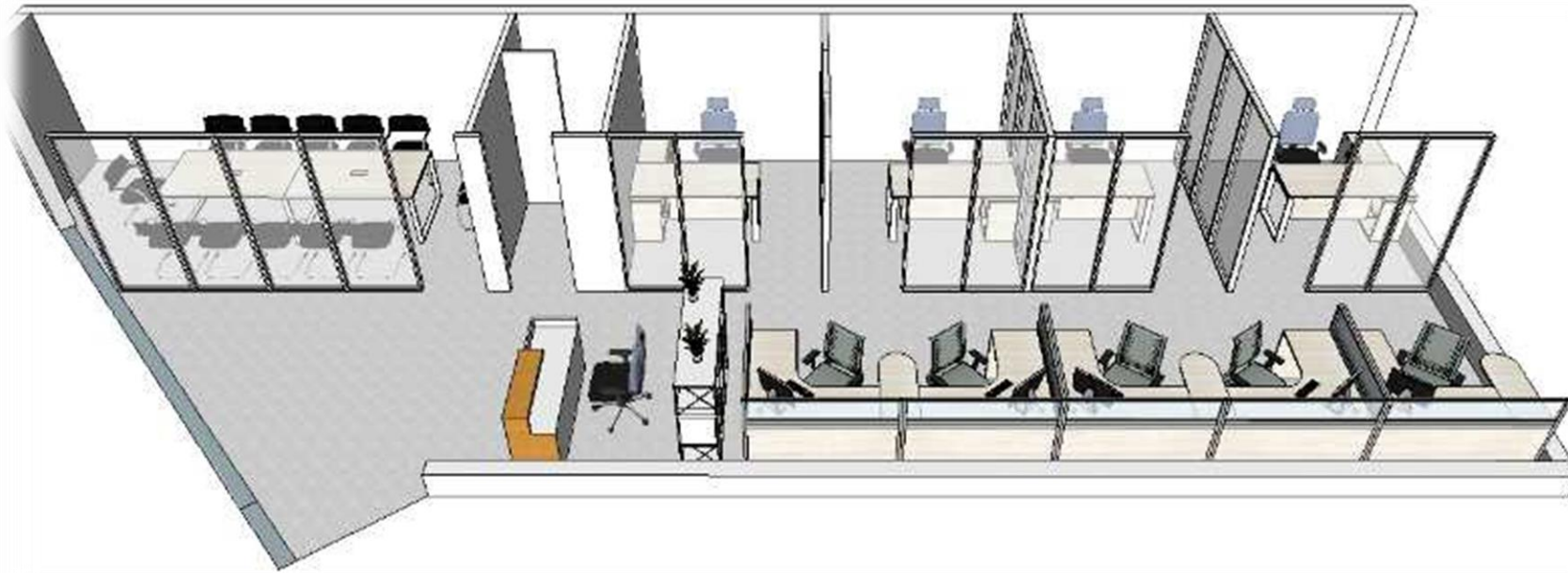

## Private and equipped offices:

- Offices of 6.96 m<sup>2</sup>
- Furnished
- Internet (Wi-Fi and fiber optic)
- Scanner, photocopier, printer
- Possibility to add phone line under request
- Desk and chairs provided

# SHENZHEN OFFERS

MENTION	WORK STATIONS	PHONE LINES	PRICE* IN RMB/ MONTH
Medium private office	1	none	5,000 RMB
Working desk in open space	1	none	3,000 RMB

\*Price subject to V. A. T. at 6.72%

Possibility to add phone line under request

Desk, Chairs, Phones & Closets provided

## TERMS & CONDITIONS:

- **Contract** : minimum 2 months - basic contract 12 month basis
- **Deposit** : 2 months
- **Notification period** : 2 months
- **Invoicing** : monthly, in RMB
- **Payment** : RMB or EURO currencies accepted

# SHENZHEN SERVICES



## Offices available for 24/7

→ with an individual electronic card.



## Free CCI FRANCE CHINE membership if rental contract more than 1 year:

- publication into our yearly Directory
- free access or with discounted price to Conferences, Working groups and all CCI events
- Discounted price for Training and Recruiting services



## Free use of meeting rooms

→ Conference room (up to 8 seats) available under request according to availabilities



Internet → WIFI + Wires



All included



Free Shared printer, scanner, copier



Private phone lines

→ direct line / extension via standard under request.



Coffee, tea and water at-will.



Business center assistant

→ (Front desk): receive your guests, call forwarding, sending letters and parcels.



# LeBooster

Contact us for more details!

## BEIJING

### **Anaëlle Wu**

*Business Center Manager*  
[wu.anaelle@ccifc.org](mailto:wu.anaelle@ccifc.org)  
+86 10 6461 0260

### **Morgan Lefevre**

*Beijing Branch Director*  
[lefevre.morgan@ccifc.org](mailto:lefevre.morgan@ccifc.org)  
+86 10 6461 0260

### **Walter Janvier**

*Business Coordinator*  
[janvier.walter@ccifc.org](mailto:janvier.walter@ccifc.org)  
+86 10 6461 0260

## SHANGHAI

### **Pascal Chen**

*Shanghai Branch Director*  
[Chen.pascal@ccifc.org](mailto:Chen.pascal@ccifc.org)  
+86 159 0173 7105

### **Lin Long**

*Business center Officer*  
[Lin.long@ccifc.org](mailto:Lin.long@ccifc.org)  
+86 21 6132 7118

## GUANGZHOU

### **Sarah DEFRANCE**

*Business Development Manager*  
[defrance.sarah@ccifc.org](mailto:defrance.sarah@ccifc.org)  
+86 (20) 2916 5529

### **Ophélie YAN**

*South China Membership &  
Business Center Manager*  
[yan.ophelie@ccifc.org](mailto:yan.ophelie@ccifc.org)  
+86 (20) 2916 5530

## SHENZHEN

### **Laurence LIU**

*Commercial and Event Assistant*  
[liu.laurence@ccifc.org](mailto:liu.laurence@ccifc.org)  
+86 (755) 8632 9602

### **Béatrice DE LA TULLAYE**

*Shenzhen Branch Director*  
[delatullaye.beatrice@ccifc.org](mailto:delatullaye.beatrice@ccifc.org)  
+86 (755) 8632 9720