



# LeBooster

Beijing • Shanghai • Guangzhou • Shenzhen

**MORE THAN A BUSINESS CENTER**

# BUSINESS CENTERS IN CHINA

To help your company settle in China!

**We offer within a friendly working environment :**

- Open spaces and private offices
- Free meeting rooms
- Visio conference system
- 24/7 accessibility
- CCI FRANCE CHINE Membership in the City of location

4

Locations

72

Companies hosted

70

Private offices

212

Desks

# BUSINESS CENTER LOCATIONS

4 Business Centers in major Chinese Cities

BEIJING



SHANGHAI



GUANGZHOU



SHENZHEN

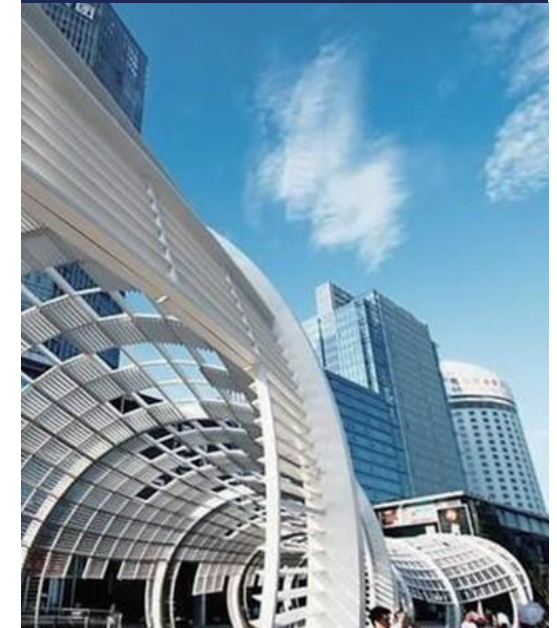

# PATRON MEMBERS

Join the 1<sup>st</sup> French network in China with more than 1600 members!



# INSTITUTIONAL PARTNERS

Get privileged contacts with our partners!

## OUR CHINESE PARTNERS



## OUR FRENCH PARTNERS





# LeBooster

## SHENZHEN

CCI FRANCE CHINE BUSINESS CENTER

**Laurence LIU**  
*Commercial and Event Assistant*  
[liu.laurence@ccifc.org](mailto:liu.laurence@ccifc.org)  
+86 (755) 8632 9602

**Béatrice DE LA TULLAYE**  
*Shenzhen Branch Director*  
[delatullaye.beatrice@ccifc.org](mailto:delatullaye.beatrice@ccifc.org)  
+86 (755) 8632 9720



# SHENZHEN LOCATION

CCI FRANCE CHINE is located in the heart of the Nanshan District.

## SHENZHEN



## HIGH-TECH INDUSTRY PARK

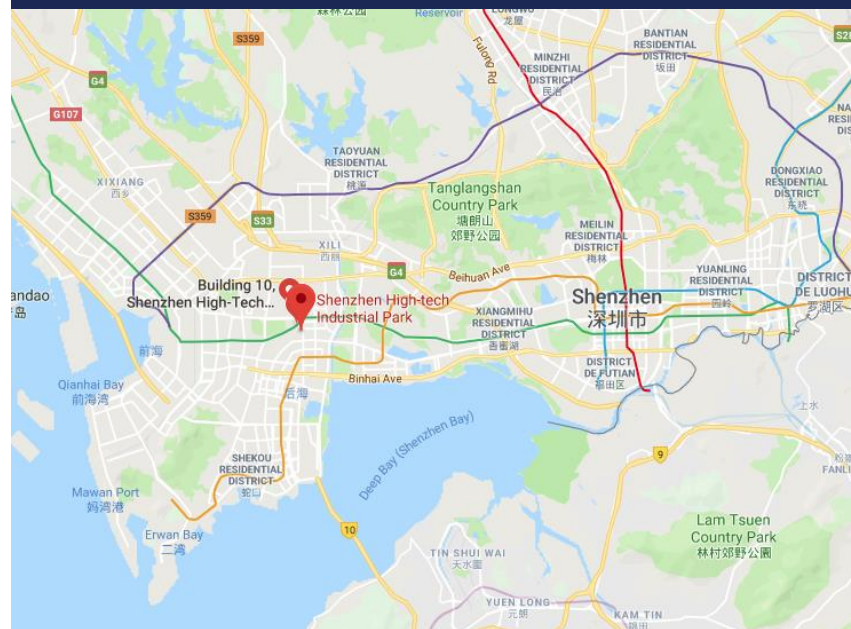

## Room 218, 2/F Chinese Overseas Scholars Venture Building



### Around us

- 2.2 km to Shenzhen Bay Park and Mixc
- 1.5 km to Shenzhen University

### Driving distance

- 40 Minutes from Shenzhen Bao'an International Airport
- 30 Minutes from Shenzhen bei Railway Station

### Walking distance

- 7 Minutes from Ke'uan Metro Station (Ligne 2, Exit C)
- 16 Minutes from Shenzhen University Metro Station (Ligne 1 Exit C)

# SHENZHEN SPACES





# SHENZHEN SURFACES

4

7

Private offices

Desks in Open Space

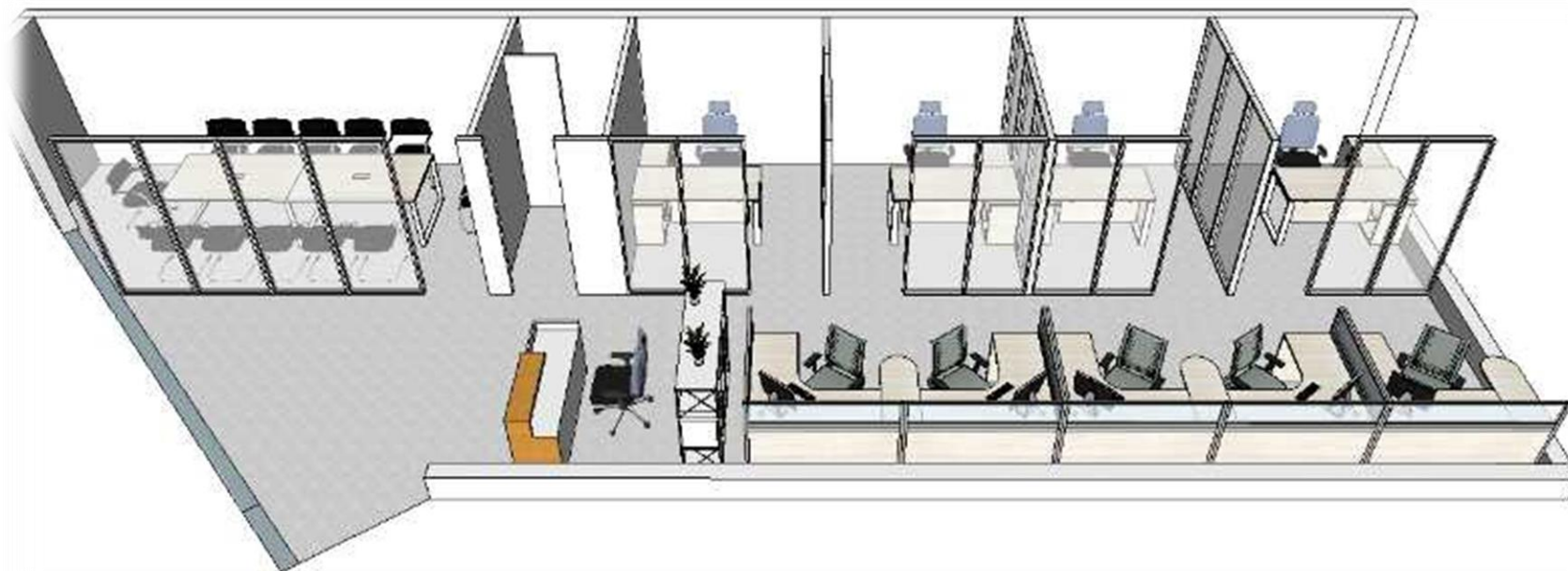

## Private and equipped offices:

- Offices of 6.96 m<sup>2</sup>
- Furnished
- Internet (Wi-Fi and fiber optic)
- Scanner, photocopier, printer
- Possibility to add phone line under request
- Desk and chairs provided

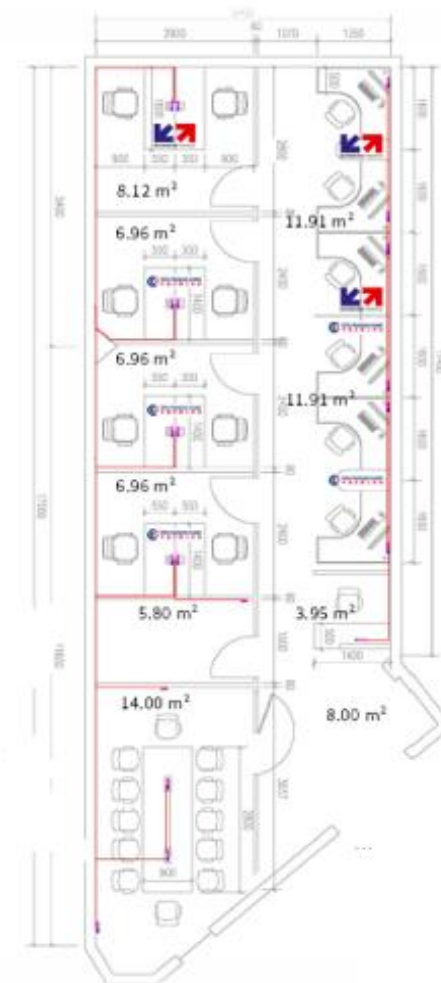

# SHENZHEN OFFERS

MENTION	WORK STATIONS	PHONE LINES	PRICE* IN RMB/ MONTH
Medium private office	2	none	5,000 RMB
Working desk in open space	1	none	3,000 RMB

\*Price subject to V. A. T. at 6.72%

Possibility to add phone line under request

Desk, Chairs, Phones & Closets provided

## TERMS & CONDITIONS:

- **Contract** : minimum 2 months - basic contract 12 month basis
- **Deposit** : 2 months
- **Notification period** : 2 months
- **Invoicing** : monthly, in RMB
- **Payment** : RMB or EURO currencies accepted

# SHENZHEN SERVICES



## Offices available for 24/7

→ with an individual electronic card.



## Free CCI FRANCE CHINE membership if rental contract more than 1 year:

- publication into our yearly Directory
- free access or with discounted price to Conferences, Working groups and all CCI events
- Discounted price for Training and Recruiting services



## Free use of meeting rooms

→ Conference room (up to 8 seats) available under request according to availabilities



Internet → WIFI + Wires



All included



Free Shared printer, scanner, copier



Private phone lines

→ direct line / extension via standard under request.



Coffee, tea and water at-will.



Business center assistant

→ (Front desk): receive your guests, call forwarding, sending letters and parcels.



# LeBooster

Contact us for more details!

## BEIJING

### **Anaëlle Wu**

*Business Center Manager*  
[wu.anaelle@ccifc.org](mailto:wu.anaelle@ccifc.org)  
+86 10 6461 0260

### **Morgan Lefevre**

*Beijing Branch Director*  
[lefevre.morgan@ccifc.org](mailto:lefevre.morgan@ccifc.org)  
+86 10 6461 0260

### **Walter Janvier**

*Business Coordinator*  
[janvier.walter@ccifc.org](mailto:janvier.walter@ccifc.org)  
+86 10 6461 0260

## SHANGHAI

### **Lin Long**

*Business center Officer*  
[Lin.long@ccifc.org](mailto:Lin.long@ccifc.org)  
+86 21 6132 7118

### **Anthony Lopez-M**

*Deputy General Manager*  
[Lopez.anthony@ccifc.org](mailto:Lopez.anthony@ccifc.org)  
+86 159 0173 7053

## GUANGZHOU

### **Hervé LAMBELIN**

*South China Branch Director*  
[lambelin.herve@ccifc.org](mailto:lambelin.herve@ccifc.org)  
+86 (20) 2916 5512

### **Ophélie YAN**

*South China Membership &  
Business Center Manager*  
[yan.ophelie@ccifc.org](mailto:yan.ophelie@ccifc.org)  
+86 (20) 2916 5530

## SHENZHEN

### **Laurence LIU**

*Commercial and Event Assistant*  
[liu.laurence@ccifc.org](mailto:liu.laurence@ccifc.org)  
+86 (755) 8632 9602

### **Béatrice DE LA TULLAYE**

*Shenzhen Branch Director*  
[delatullaye.beatrice@ccifc.org](mailto:delatullaye.beatrice@ccifc.org)  
+86 (755) 8632 9720